

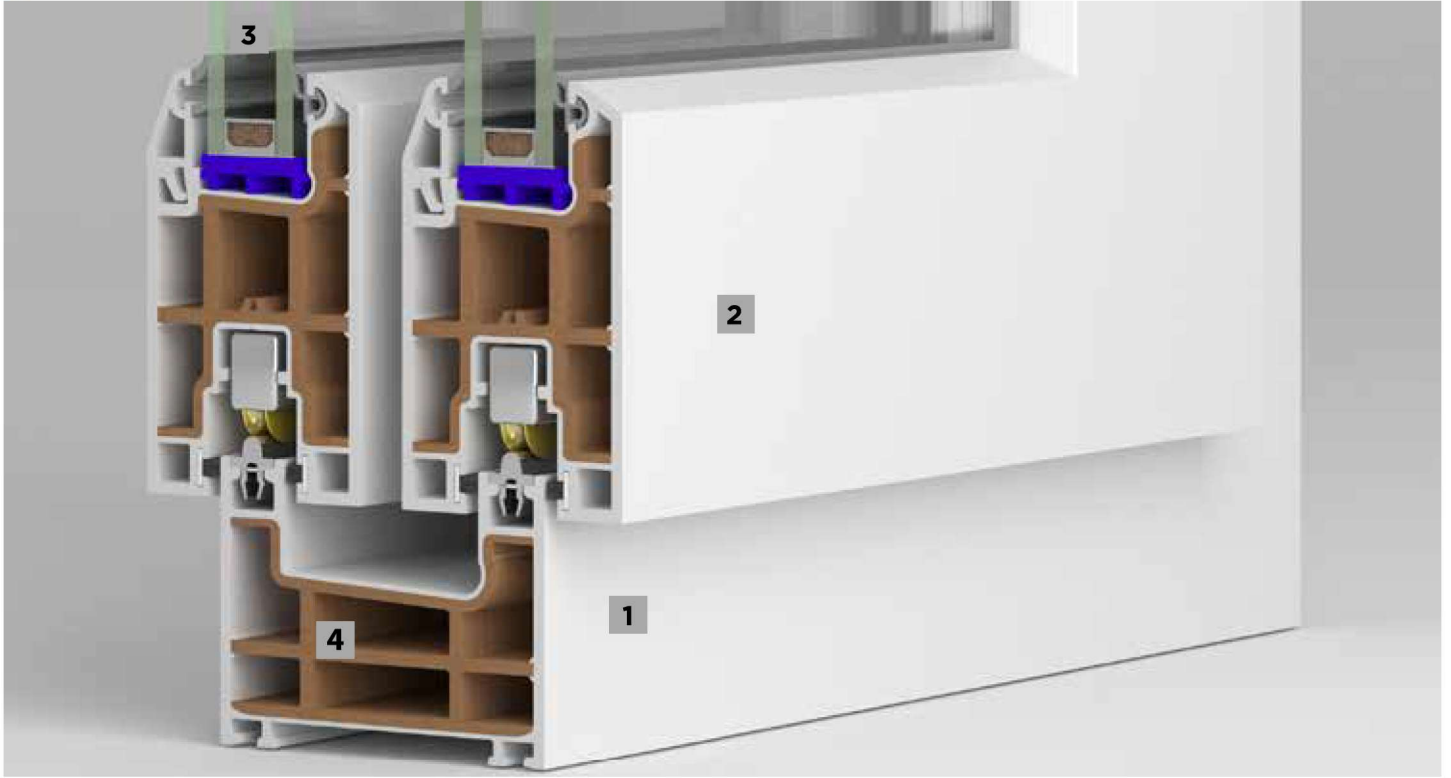

 **ADOPEN®**

**PENWOOD 232 SÜRME SERİSİ
PVC PROFİL SİSTEMLERİ**



TEKNİK

Penwood 232 SÜRME SERİSİ

Profil Geniřlięi: 75 mm geniřlikte çift raylı kasa ve 92.5mm geniřlikte tek raylı kasa ile 50mm geniřlikte sürme kanat profili

Odacık Sayısı: 3 Odacıklı Sistem

Profil Sınıfı: B Class (TS EN 12608-1)

Conta Sistem: Kıl fitil izolasyonlu sistem

Conta Tipi/Rengi: TPE - Gri / Siyah

Cam Kalınlıkları (mm): 4-6, 20, 24 mm

Isı İletim Katsayısı Uf: 1,43W/m²K

- 1 3 Odacıklı Kasa.
- 2 Statik Dayanımı Yüksek Kanat.
- 3 Tek ve Çift Cam Seçeneęi.

AÇIKLAMA

- 75 mm geniřlikte çift raylı kasa ve 92,5 mm geniřlikte tek raylı alternatif kasa ile 50 mm geniřlikte sürme kanat profil.
- Farklı kalınlıklarda gri contalı çıta ile tek cam (4-6 mm) ve ısıcam (20 - 24 mm) uygulama imkanı.
- Destek sacı kesimine, vidalamasına ve işçilięine ihtiyaç yok.
- Contalı kanat ara kilitlemeli sistem
- Destek Saclı Ürünlere göre % 30 Maksimum ısı, ses ve su yalıtımına sahiptir.
- Su drenaj kanalına sahip. Doğrudan delinebilir veya kesilebilir.
- Sadece kes ve kaynat. Destek sacına ve destek sacı stok alanına ihtiyacınız yok.
- Laminasyon uygulama seçenekleri.
- Ulusal ve uluslar arası ölçüm kuruluşları tarafından onaylanan kalite.

RENK SEÇENEKLERİ



PENWOOD 232 SÜRME SERİ PVC PROFİL SİSTEMİ

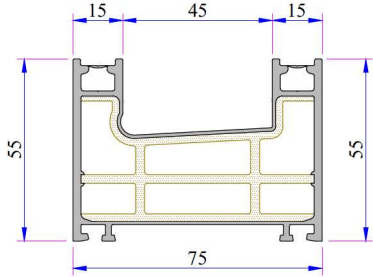

Penwood 232 Çift Raylı Kasa Profili
Code: ???

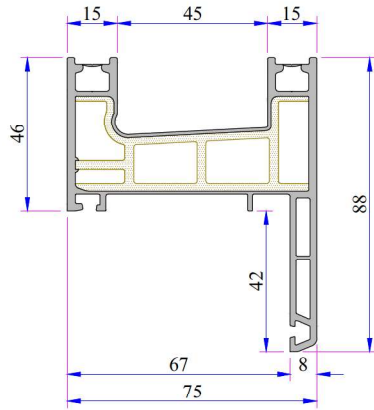

Penwood 232 Çift Raylı Pervazlı Kasa Profili
Code: ???

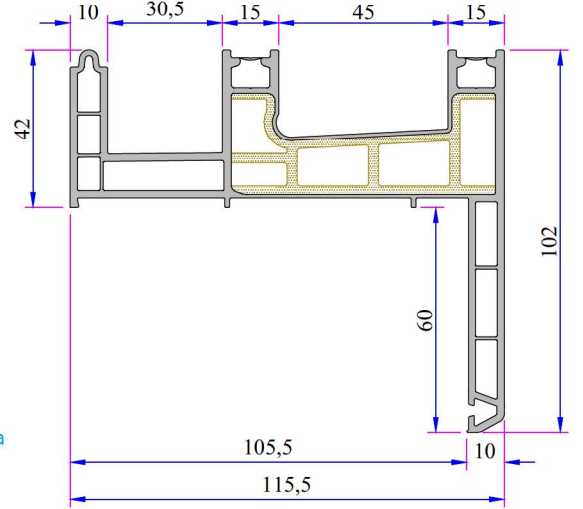

Penwood 232 Çift Raylı Pervazlı-Sineklikli Kasa Profili
Code: ???

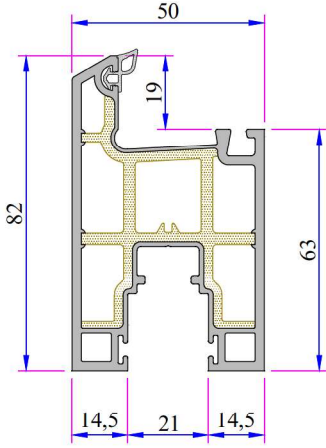

Penwood 232 Sürme Kanat Profili
Code: ???

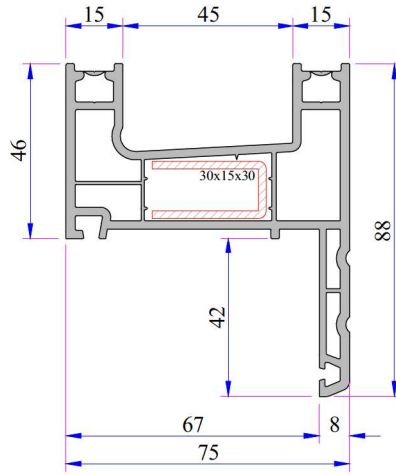

Dekoratif Pervazlı Çift Ray Kasa Profili
Kod: P.A.232.1107.600.0.00.03

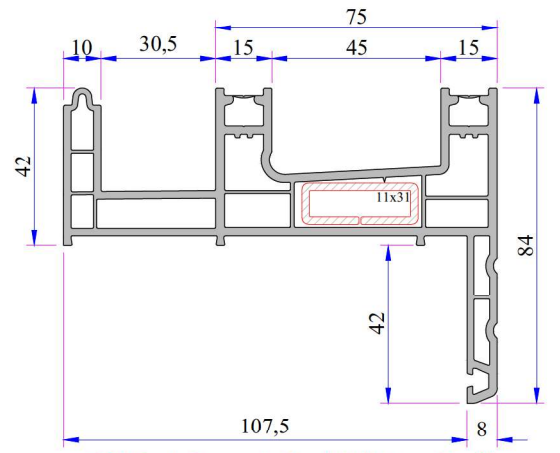

Çift Raylı Pervazlı-Sineklikli Kasa Profili
Kod: P.A.232.1109.600.0.00.03

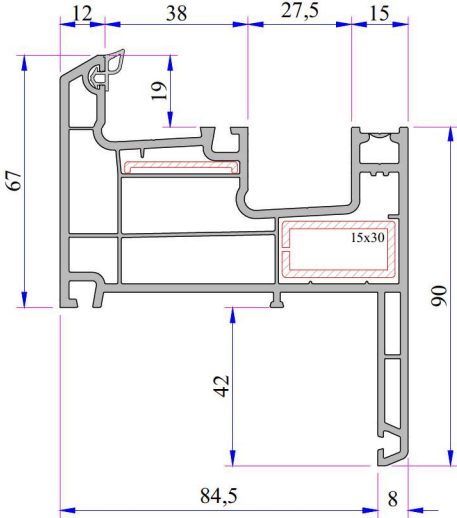

Tek Raylı Pervazlı Kasa Profili
Kod: P.A.232.1114.600.0.00.03

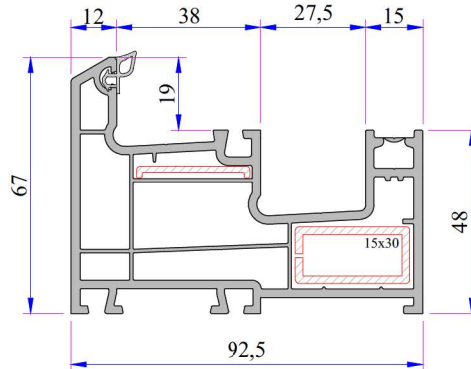

Tek Raylı Kasa Profili
Kod: P.A.232.1105.600.0.BC.03

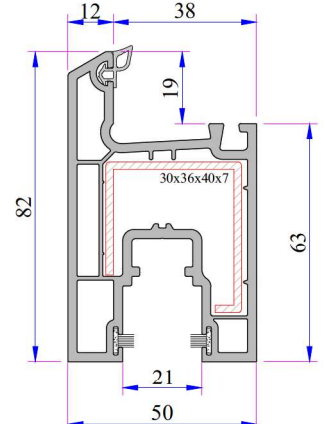

Statik Sürme Kanat Profili
Kod: P.A.232.2308.600.0.BC.03

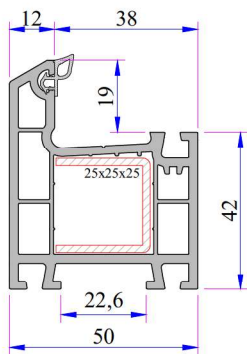

332 Kasa Profili
Kod: P.A.332.1000.600.0.BC.03

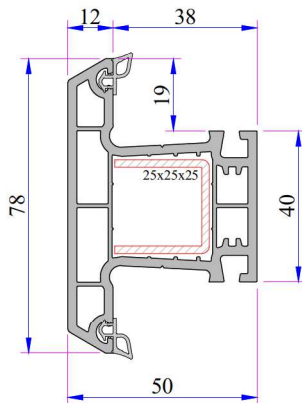

332 Orta Kayıt Profili
Kod: P.A.332.3000.600.0.BC.03

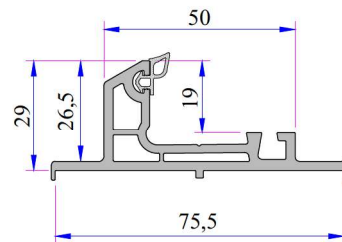

Çift Ray Adaptör Profili
Kod: P.A.232.5800.600.0.BC.19

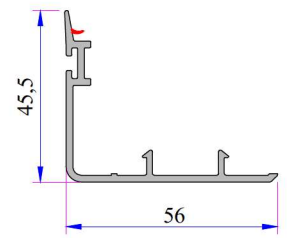

Contalı Kanat Kapama Profili
Kod: P.A.232.5709.600

PENWOOD 232 SÜRME SERİ PVC PROFİL SİSTEMİ

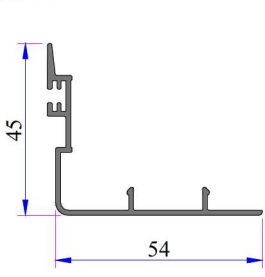

Alm. Kanat Kapama Profili
Kod: 16051.601.5.1.1.9016

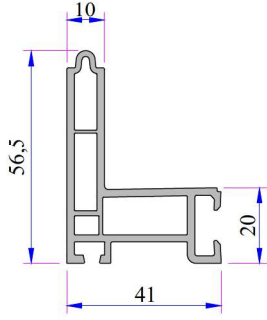

Sineklik Adaptör Profili
Kod: P.A.232.5802.600.0.00.19

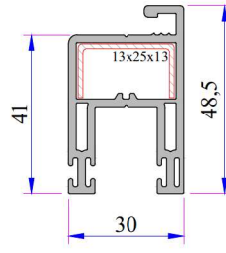

Sürme Sineklik Kanat Profili
Kod: P.A.242.2305.600.0.00.03

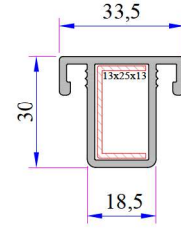

Sürme Sineklik Orta Kayıt Profili
Kod: P.A.242.3200.600.0.00.03

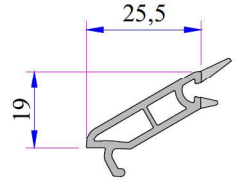

Tek Cam Çıtası (4mm)
Code: P.A.332.4000.600.0.00.HC

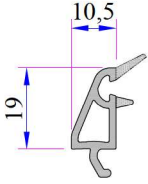

20mm Çift Cam Çıtası
Kod: P.A.332.4100.600.0.00.HC

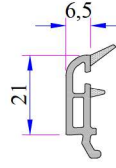

24mm Çift Cam Çıtası
Kod: P.A.532.4500.600.0.00.HC

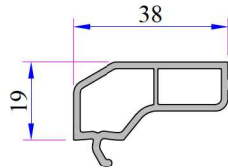

PVC Kapama Profili
Kod: P.A.232.5702.600

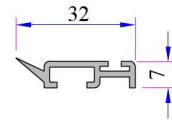

Kanat Ara Bindirme Profili
Kod: P.A.232.5301.600

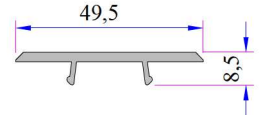

PVC Kanat Kapama Profili
Kod: P.A.232.5704.600

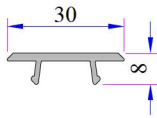

Sineklik Kanat Kapama Profili
Kod: P.A.242.5701.600

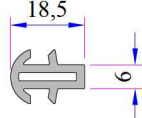

Kısa Bağ Profili
Kod: P.A.099.5003.600

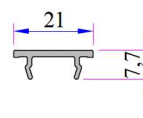

Ünlversal Kalın Bağ Kapak Profili
Kod: P.A.058.5707.600.0.00.19

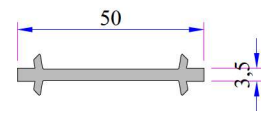

İnce Bağ Profili
Kod: P.A.050.5001.600

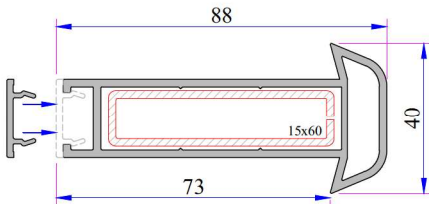

Ünlversal Kalın Bağ Profili
Kod: P.A.058.5000.600.0.00.19

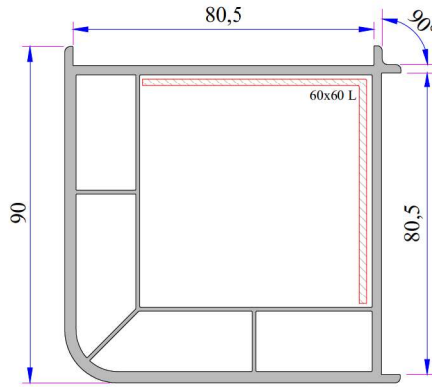

90° Köşe Dönüş Profili
Kod: P.A.080.5100.600.0.00.19

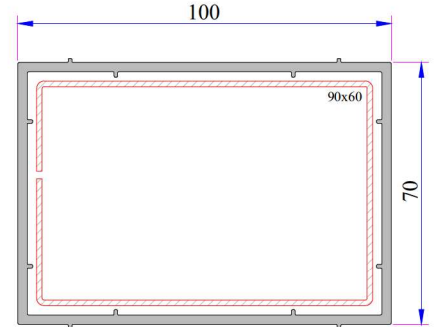

Kutu Profili 70x100mm
Kod: P.A.070.5202.600.0.00.19

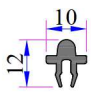

Alm. Sürme Ray Profili
Kod: 16014.601.5.0.0.0000

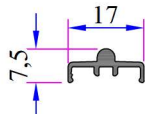

Şapkalı Alm. Sürme Ray Profili
Kod: 16053.601.5.2.0.0000

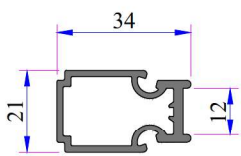

Alm. Çift Ray Adaptörü
Kod: 16011.601.5.1.1.9016

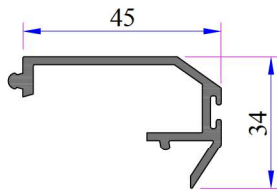

Alm. Kapama Profili
Kod: 16013.601.5.2.0.0000

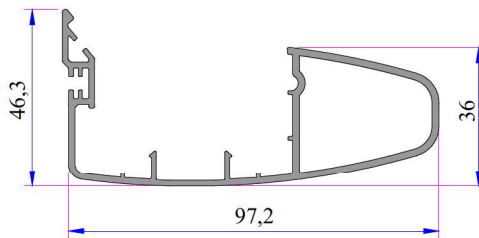

Kanat Kapama Griyaj Profili
Kod: 16028.601.5.2.0.0000

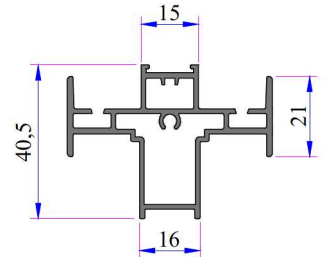

Alm. Kulaklı Çift kanat Ara Adaptörü
(Profil Yeni Yapılacak)

PENWOOD 232 SÜRME SERİ PVC PROFİL SİSTEMİ

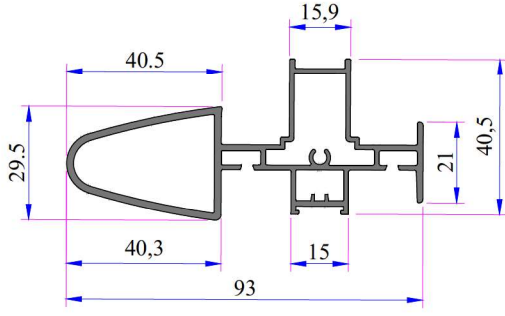

Alm. Griyajlı Çift Ray Adaptörü
(Profil Yeni Yapılacak)
Kod: P.A.332.4000.600.0.HC

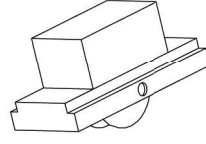

Sürme Araba
Kod: 34009-17010

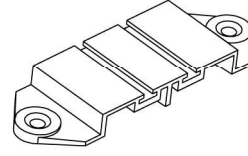

Çift Ray Sızdırmazlık
Parçası
Kod: 34009-26010

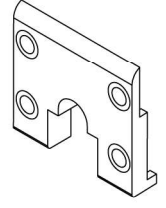

Sürme Kanat Bitiş
Parçası
Kod: 34009-46010

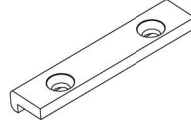

Sürme Ray Üst Yatak
Parçası
Kod: 34009-36010

Penwood 232 Destek Sacı Profilleri

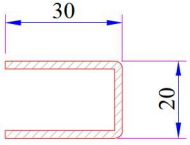

Çift Ray Kasa Profili
Destek Sacı
Kod: 34022-12006

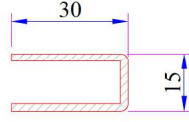

Dekoratif ve Düz Pervazlı Kasa
Profili Destek Sacı
Kod: 34022-12034

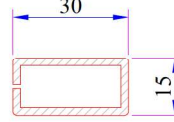

Tek Ray Sürme Kasa - Eko Tek
Ray Sürme Kasa Profili Destek
Sacı
Kod: 34022-12125

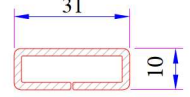

Dış Sineklik Raylı Sürme
Kasa Profili Destek Sacı
Kod: 34022-12107

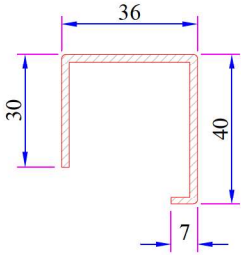

Statik Sürme Kanat Profili
Destek Sacı
Kod: 34022-12036

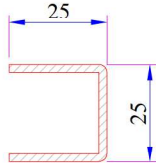

332 Kasa - Orta Kayıt Profili
Destek Sacı
Kod: 34022-12003

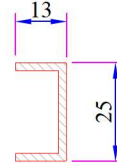

Sürme Sineklik Kanat ve Orta
Kayıt Destek Sacı
Code: 34022-12008

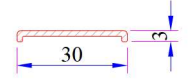

Tek Ray Sürme Kasa - Eko Tek
Ray Sürme Kasa Profili Destek
Sacı
Kod: 34022-12035

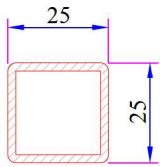

Orta Kayıt Profili Statik Destek
Sacı
Kod: 34022-12122

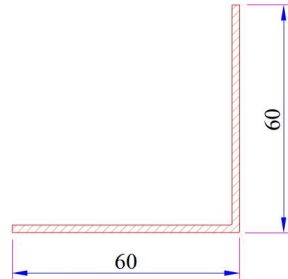

90° Köşe Dönüş Profili Destek
Sacı
Kod: 34022-12306

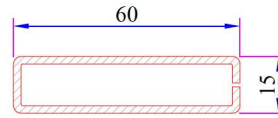

Üniversal Kalın Bağ Profili
Destek Sacı
Code: 34022-12123

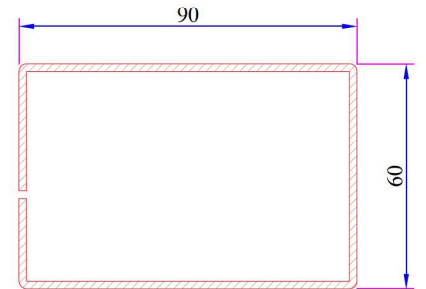

Kutu Profili Destek Sacı
Kod: 34022-12121

Penwood 232 Montajlar

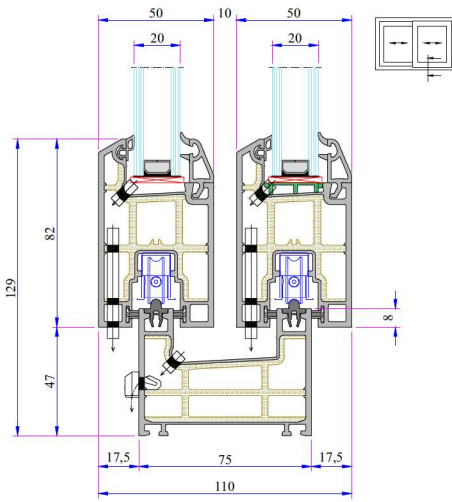

Çift Raylı Sürme Kasa - Kanat Montajı

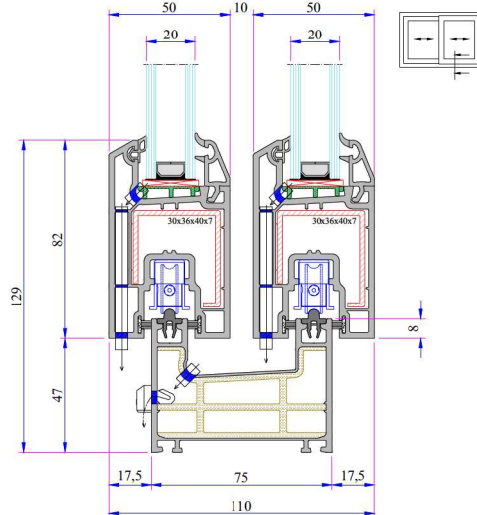

Çift Raylı Sürme Kasa - Statik Sürme Kanat Montajı

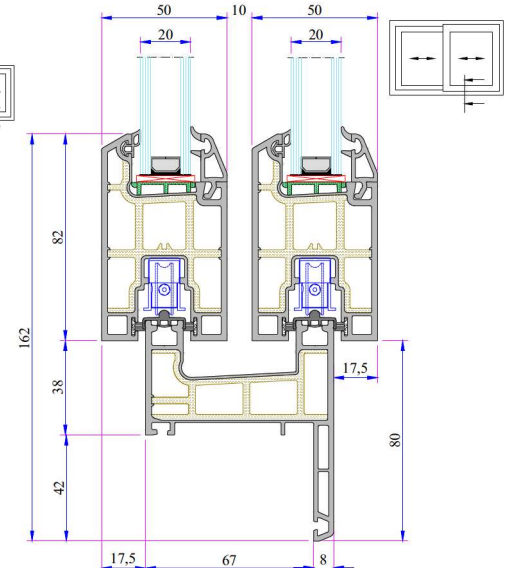

Çift Raylı Düz Pervazlı Sürme Kasa - Kanat Montajı

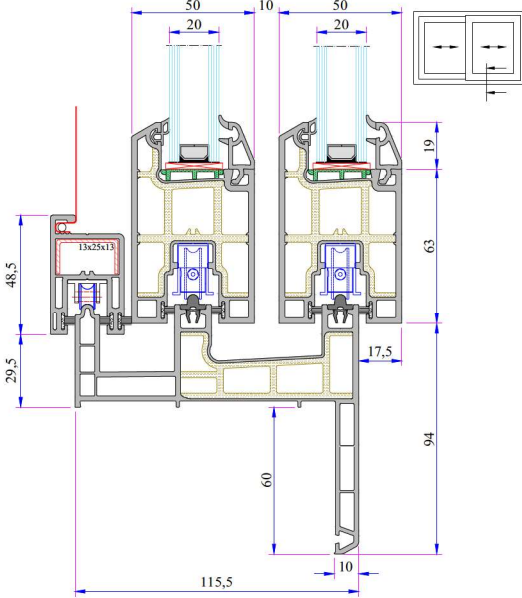

60mm Sürme Pervazlı Sineklik Kasa - Kanat Montajı

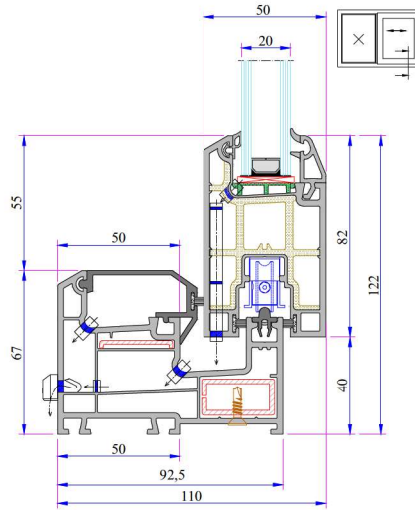

Tek Raylı Sürme Kasa - Kanat Montajı

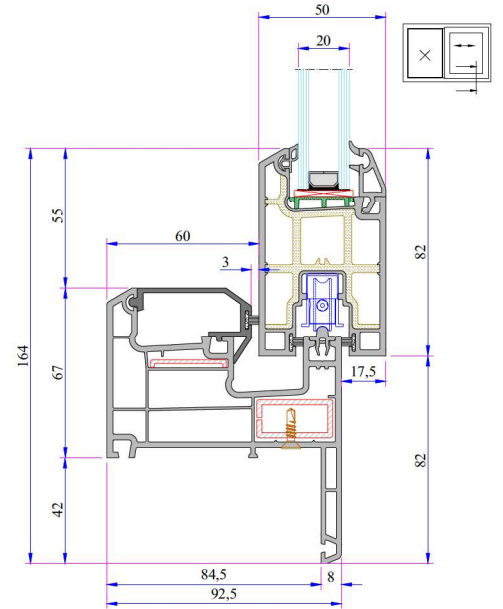

Tek raylı Pervazlı Sürme Kasa - Kanat Montajı

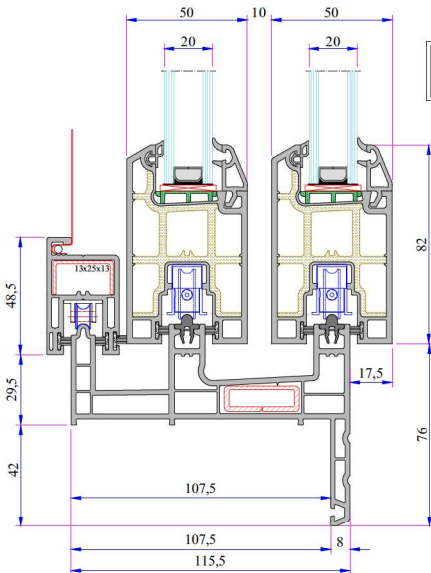

Sürme Pervazlı Sineklik Kasa - Kanat Montajı

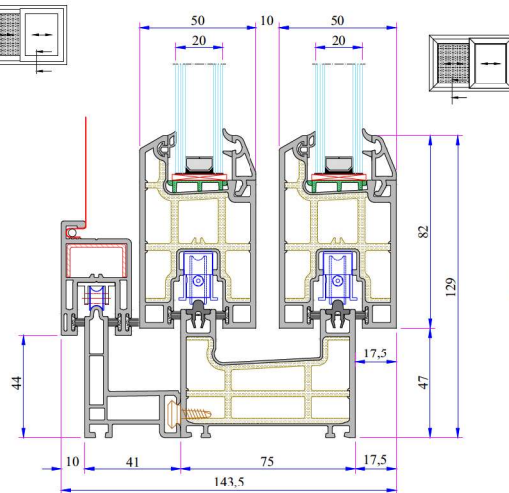

Çift Ray Sürme Kasa - Sürme Kanat - Sineklik Ray Profili Montaj Detayı

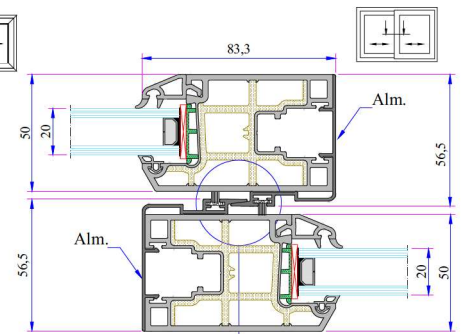

Alternatif 1

Alm. Sash Cover Profile Installation

PENWOOD 232 SÜRME SERİ PVC PROFİL SİSTEMİ

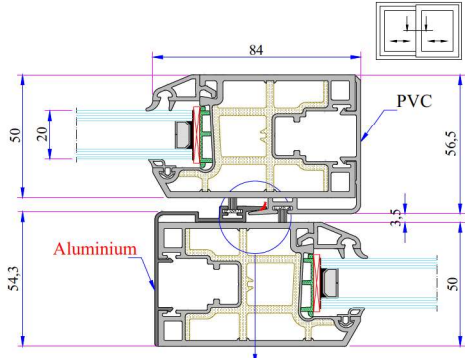

Alternatif 2

PVC ve Alüminyum Kanat Ara
Bindirme Montaj Detayı

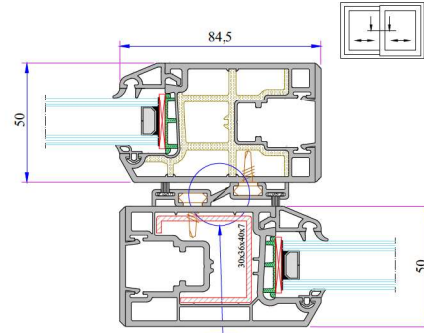

Alternatif 3

Kanat Arka Kapama ve Kanat
Ara Bindirme Montaj Detayı

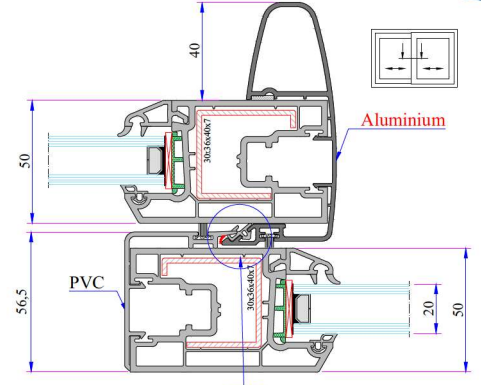

Alternatif 4

Alm. Kanat Kapama Griyaj
Profili

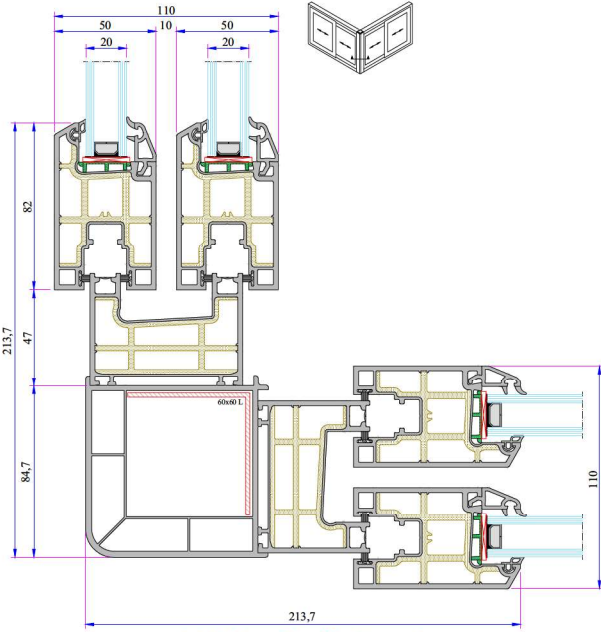

90° Köşe Profili Montajı

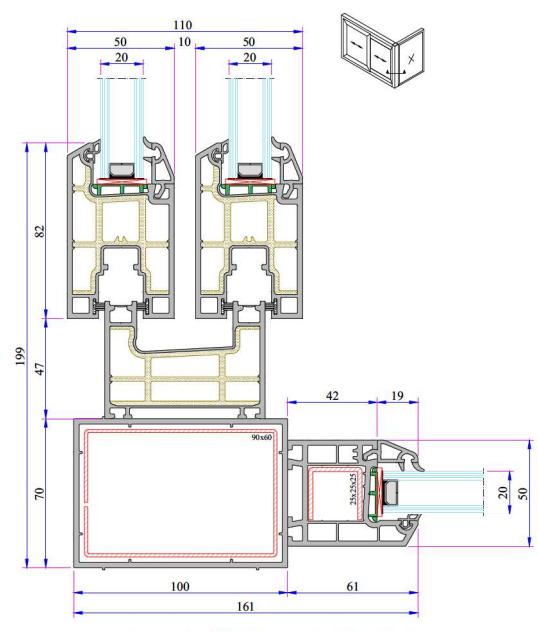

Kutu Profili Montajı (70x100)

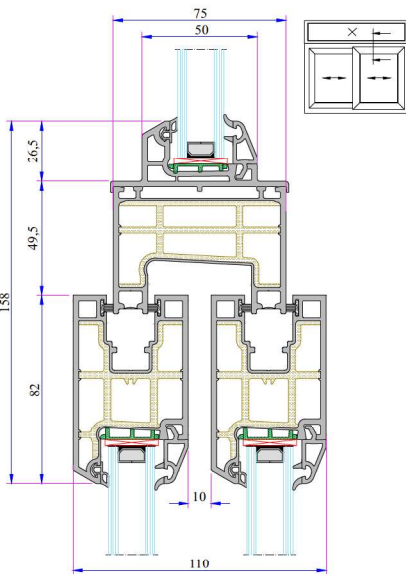

Üst Sabit Alt Çift Ray Sürme
Montaj Detayı

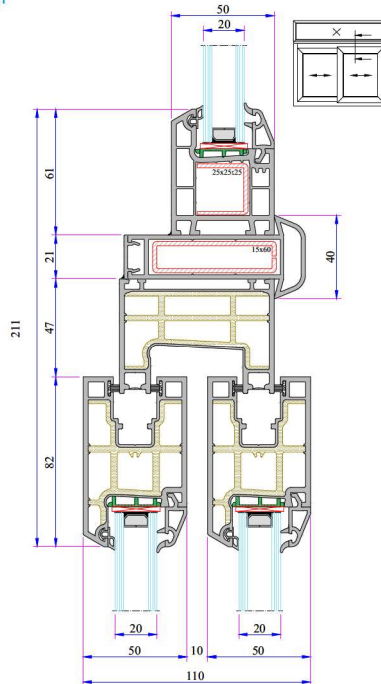

Üniversal Kalın Bağ Profili
Montajı

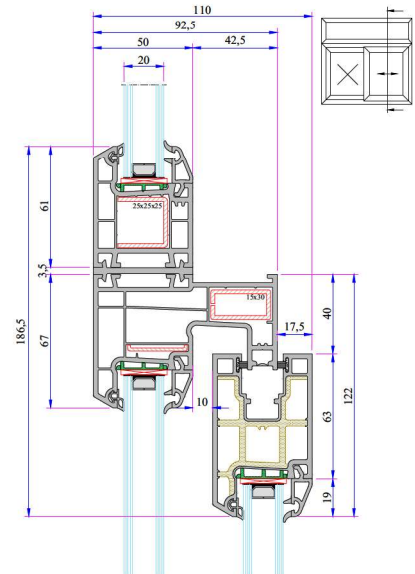

Üst Sabit Alt Tek Ray Sürme
Montaj Detayı

Project name:	232 Penwood		
	Sliding		
	Sash-Sash Uf		
Transmittance (Uf):	1.4336 W/m ² K	Internal T:	20.00 °C
Conductance (Lf2D):	0.6345 W/mK	External T:	0.00 °C
Frame length (Bf):	85.08 mm		



Thermal transmittance (Uf) computation performed in accordance with EN ISO 10077-2:2012

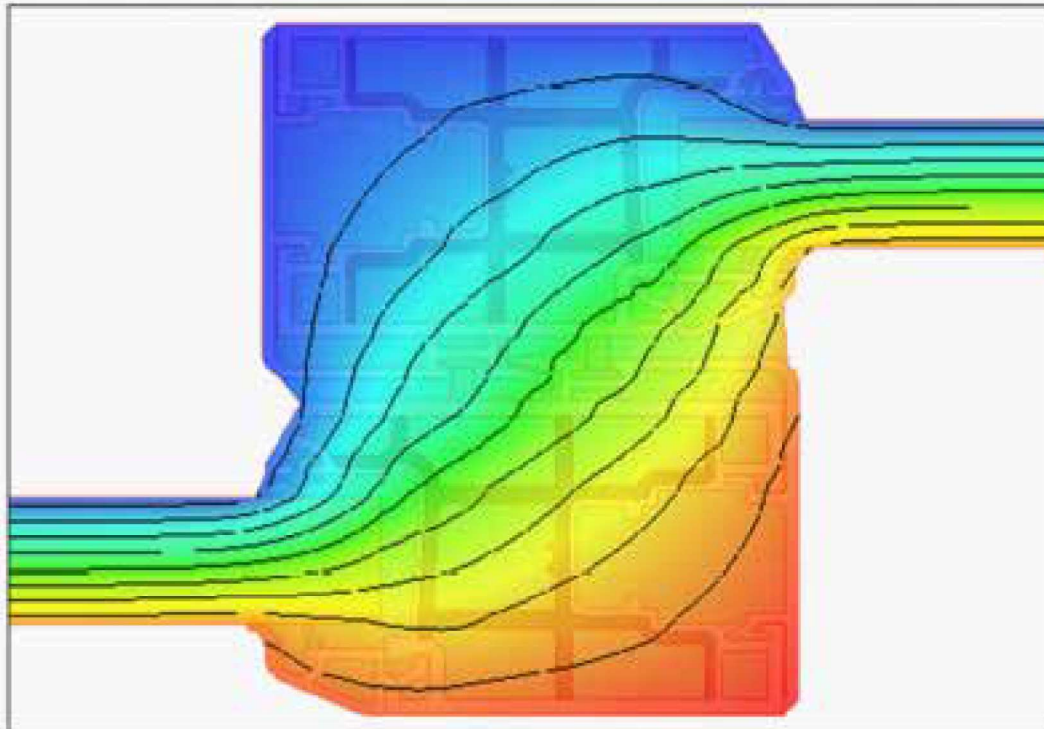

0.08 19.38

Node details

Primitives used for finite element simulation:	28461
Frame width (Bf):	85.08 mm
Visible insulation panel width (Bp):	380.01 mm
Insulation panel thickness (Dp):	-

External boundary conditions:

Temperature:	0.00 °C
Surface resistance:	0.040 m ² K/W

Internal boundary conditions:

Temperature:	20.00 °C
Surface resistance:	0.130 m ² K/W
Humidity:	65.00 %

Results computed in accordance with EN ISO 10077-2:2012

Internal/external temperature difference:	20.00 °C
2D conductance (Lf2D):	0.6345 W/mK
Transmittance (Uf):	1.4336 W/m²K



FACTORY

Antalya Organize Sanayi Bölgesi 2.Kısım Mah. 21.Cadde No:3

07040 Döşemealtı / ANTALYA / TURKEY

Tel : +90 242 236 20 00 · Faks : +90 242 236 20 90 · Email : info@ado.com.tr

